



**PERIO PAIR:** Dr. Lindsay Eastman will welcome the oldest of his four children, Christie, 29, to Eastman Periodontics & Implants in July 2016. A DMD who graduated in May 2013 from the University of Florida College of Dentistry, Christie is a second-year resident in the perio department.



# A LABOR OF LOVE

FOR TAMPA-AREA PERIODONTIST LINDSAY EASTMAN, OPENING A SECOND PRACTICE VIA GUT RENOVATION WAS VERY MUCH IN ALIGNMENT WITH HIS PASSIONS.

**BY KRISTIE CERUTI**  
**PHOTOGRAPHY BY STEVEN P. WIDOFF**

**CULTIVATION OF ANY KIND** — agricultural, architectural, spiritual — requires plenty of time, patience and heart. For Bradenton, Florida, periodontist Lindsay Eastman, nurturing an atmosphere of growth at his two practices requires the same skill set as maintaining the 45 fruit trees that grow on the riverfront property at his home.

The doctor, 62, credits his parents with instilling his lifelong dedication to love, integrity and family . . . and that green thumb.

He drew on all those influences in 2013 when, after 27 years in the same location, he began major renovations on a second practice in Lakewood Ranch, just southeast of Bradenton. (The new facility opened last February; his 16 staffers rotate between the two.)

A Periolase expert, Dr. Eastman prioritized the acquisition of leading-edge technology in the second office. A passionate educator — he was instrumental in initiating the hygiene program at Manatee College and is now a professor at the University of Florida — he also hosts a Seattle Study Club in an area of the new practice with a retractable wall that can accommodate two dozen eager learners.

He made sure to seek the opinions of his staff throughout the renovation process, too. “You might be smarter than me, but not smarter than my whole team,” he says.

The major contributors, he readily admits, were his wife, Marny, and Benco Dental interior-design specialist Amanda Griffith — “except one thing I had control over: I wanted a wall of family pictures,” he says. “Isn’t that what it’s all about — family?” ■



**An open area** that serves as a meeting room for Dr. Eastman's Manatee Study Club doesn't sacrifice space; instead, he says, the retractable wall makes it convertible. Dr. Eastman's team member Brett Muncie serves as the study club's coordinator.

**The hub of the office** is sensibly planned and spacious, contributing to an atmosphere of organization and productivity.



Steven P. Widoff Photography: widoffphoto.com

**Downlighting** on the reception desk highlights a calming color palette of blues, tans and cream.



**Dr. Eastman likes to stay up to date** on the latest technology, such as this Vatech PaX-i3D, which offers him powerful diagnostics.



**Cherry Midmark cabinetry** lends privacy and minimalist elegance to five patient operatories.

**Dr. Eastman's practice** is modeled on one of the doctor's favorite quotations, from management-consulting guru Jim Pride: "Spectacular achievement is always preceded by unspectacular preparation." A fitting sentiment for this clean, spare, organized sterilization center, no?



**When sliding doors** in the team lounge open, the expanded space comfortably seats two dozen study-club members. The mini-kitchen, equipped with everything Dr. Eastman's staff needs to refuel and unwind, is an attraction as well.





**The large screen** in the cozy consult room enables Dr. Eastman to educate his patients on treatment options, from the Pinhole Surgical Technique to Lanap laser treatment.



**The family photo wall** is a patient favorite. "One photo features my four children dressed in toothpaste tubes for Halloween," Dr. Eastman says.



**DESIGN TEAM**

**Builder:** Gerdes Construction / Daniel J. Gerdes

**Architect:** Ugarte & Associates / David Bishop

**Interior Design:** Amanda Griffith / CenterPoint Design

**Equipment Specialists:** Doug Hughes, Dennis Chaples / Benco Dental

**Friendly Benco Rep:** Kathy Kline

**The practice's layout began** with considerations of patient flow and clinical efficiency. The rest of the floor plan emerged from there.

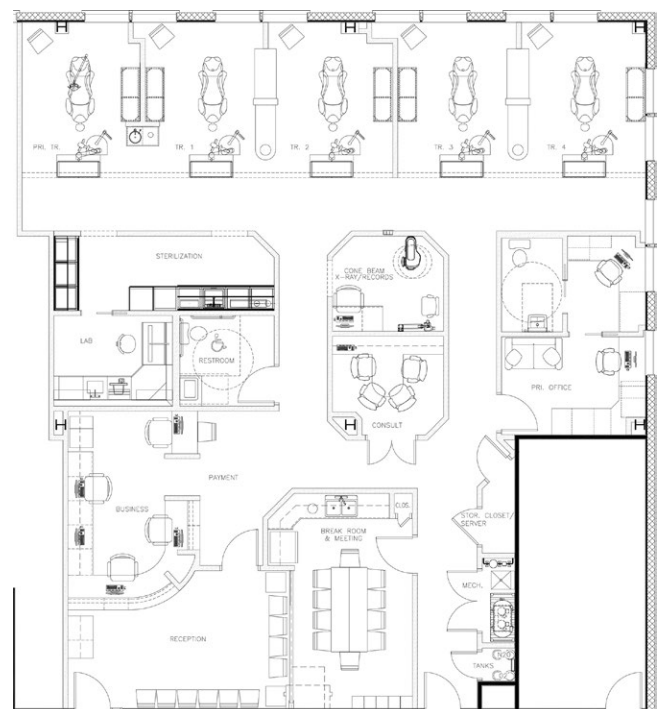

The new 911 Turbo S is so high up on the indulgence scale that it could almost be considered papal, but its urbane manners remain soothing for daily use — and really, why shouldn't you sip some champagne every day?



**HELLO FROM THE FLIGHT DECK:** The Panamera's cockpit, ready for takeoff

as opposed to the cramped quarter-scale seat model the 911 offers. However, the Panamera has found plenty of buyers among those who wanted a Porsche car — as distinct from a Porsche SUV — with room for kids, gear, all the stuff of modern life.

Because the Porsche 911 is akin to the embryonic stem cell of the brand, our interest in the Panamera was seeing how Porsche has used its source DNA to expand the family. With “just” 520 horses from its 4.8-liter V8 (mounted up front, if you're wondering) and more weight to carry, the Panamera dispenses a different kind of thrill — but we found it pretty much the equal of the 911 in every respect.

This time, we were heading up the Pacific Coast Highway to Santa Barbara, so we made detours into several canyons to test the sedan's reflexes. Well, the first one was a test, anyway; after that, every canyon run was purely for enjoyment. The Panamera's a

Whereas the 911 cockpit represents well-appointed purpose, meanwhile — there are no buttons on its steering wheel — the Panamera's cabin is truly lush, a luxe-at-first-sight lair gratifying enough to excuse the abundance of thin chrome buttons. Its longer wheelbase and increased heft made the Panamera slightly more graceful over imperfect roads and through bumpy corners under acceleration, while it retained the fearlessness and aptitude of the 911 when it came to attacking any set of curves.

When it's time to forsake the Mr. Hyde persona, set the cruise to 65 miles per hour and cover ground in the relaxed grandeur that Dr. Jekyll (or any other doctor)

Porsche, all right: Energetic acceleration makes every lane an express lane, and the sport exhaust is actually more aurally rewarding than that of the 911 — we gave the throttle a workout just because we liked the sound, not because we needed to go any faster.

has a right to expect. The traits junior has inherited from the paterfamilias 911 are so recognizable that we shouldn't consider it a four-door Porsche; it's a four-door 911.

The 911, like champagne, has long been a victim of the sense of achievement it confers on buyers — it would bring more joy to more people if it weren't viewed as a special-occasion indulgence. The new 911 Turbo S is so high up on the indulgence scale it could almost be considered papal, but its urbane manners remain soothing for daily use — and really, why shouldn't you sip some champagne every day? And should you need your elixir to serve four — whether in a crystal flute or a sippy cup — your companions will be just as happy, we promise, with the vintage labeled Panamera. ■

*Automotive writer JONATHAN RAMSEY's work has appeared in the New York Times, the Robb Report, Elite Traveler and Variety. He last wrote for Incisal Edge about the BMW 4 Series convertible.*



**SCENIC OVERLOOK:** Just remember to close that door before you get moving again.

## Flexicut Files : Ideal for Negotiating Curved Canals



**ROYDENT**  
DENTAL PRODUCTS

- Triangular cross section allows for better negotiation of curved canals.
- Three sharp edges for maximum cutting efficiency
- Conical, non-cutting tip follows canal curve
- Standard .02 taper
- Color of pre-applied silicone stop identifies file length
- Manufactured in Germany.
- Made with German stainless steel.

*To receive FREE product, fax qualified Benco Dental invoice dated 3/1/15 to 5/31/15 to Roydent Dental Products (888) 769-3368 with promo code RGV identified on or before 5/15/2014. You may also email invoice to [promos@roydent.com](mailto:promos@roydent.com). One qualifying invoice per redemption. Please indicate name, size and length of free product to be of equal or lesser value. Allow 4-6 weeks for delivery. Not to be combined with any other Roydent offer. USA only.*

**BUY 3 PACKS, GET 1 FREE!**  
To order, see your Friendly Benco Rep or call  
**1.800.GO.BENCO (1.800.462.3626).**



## Osprey™ Compressors from RAMVAC®



- RAMVAC compressor heads are 100% duty cycle rated and run at 115 PSI max operating pressure, allowing them to run unremittingly if needed.
- Dual column desiccant dryer provides 100% continuous supply of the driest cleanest air in the dental industry.
- Rocking piston design technology provides quiet operation while still producing more peak airflow than other compressors on the market.
- RAMVAC Compressors have the best warranty in the industry – 6 years/4200hours!
- Basic or Smart control platforms are available.
- Osprey Sound Covers are now also available for all Osprey models to reduce noise levels by 6-8 decibels (dBA).

**See your Friendly Benco Rep. Call 1.800.GO.BENCO (1.800.462.3626).**

## When performance counts, Provisa® CEM GI delivers... *without an activator!*

- Glass Ionomer Application Capsules
- New, unique capsule technology - No activator needed!
- Suitable for large restorations
- High translucency for aesthetic results
- High compressive strength
- Continuous fluoride release
- 50 capsules per box, order # [4856-131]



**See your Friendly Benco Rep.  
Call 1.800.GO.BENCO.**

**Benco Dental**  
We deliver success smile after smile.  
800.GO.BENCO • [benco.com](http://benco.com)  
296 CenterPoint Blvd., Pitsboro, PA 18640  
Made in Germany